

BASE AND NUT

Black-oxide steel, class 10 (tensile strength 1000 N/mm²).

FEATURES AND APPLICATIONS

GN 347 hexagon nuts with levelling base are mainly used to lock metal parts with surfaces inclinable by max 3°. The locking plane is not affected by the rotation of the nut.

Application example

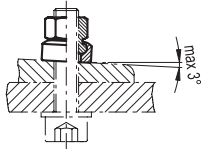

Conversion Table 1 mm = 0.039 inch	
d1	
mm	inch
17	0.63
21	0.83
24	0.94
30	1.18
36	1.42
44	1.73

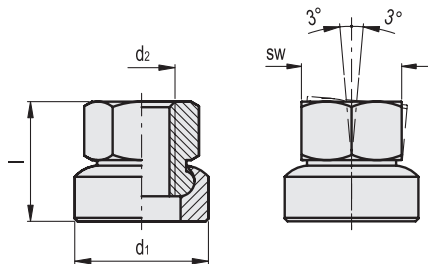

Code	Description	d1	d2	l	sw	⚖
GN.14941	GN 347-17-M8	17	M8	14	13	12
GN.14942	GN 347-21-M10	21	M10	17.5	16	24
GN.14943	GN 347-24-M12	24	M12	21.5	18	37
GN.14944	GN 347-30-M16	30	M16	28	24	75
GN.14945	GN 347-36-M20	36	M20	35	30	140
GN.14946	GN 347-44-M24	44	M24	42.5	36	261

- 1
- 2
- 3
- 4
- 5
- 6
- 7
- 8
- 9
- 10
- 11
- 12
- 13
- 14
- 15
- 16
- 17
- 18

Machine elements